

AERODROME CHART - ICAO	ARP : 57 05 34.04N 009 50 56.99E	AD ELEV : 10 FT	ELEV in FT Dimensions / Distances in M	Aalborg APP : 123.975 309.950 Aalborg TWR : 118.300 284.775 ATIS : 120.475	AD 2 - EKYT ADC (CIV / MIL) Aalborg
-------------------------------	-------------------------------------	-----------------	---	--	--

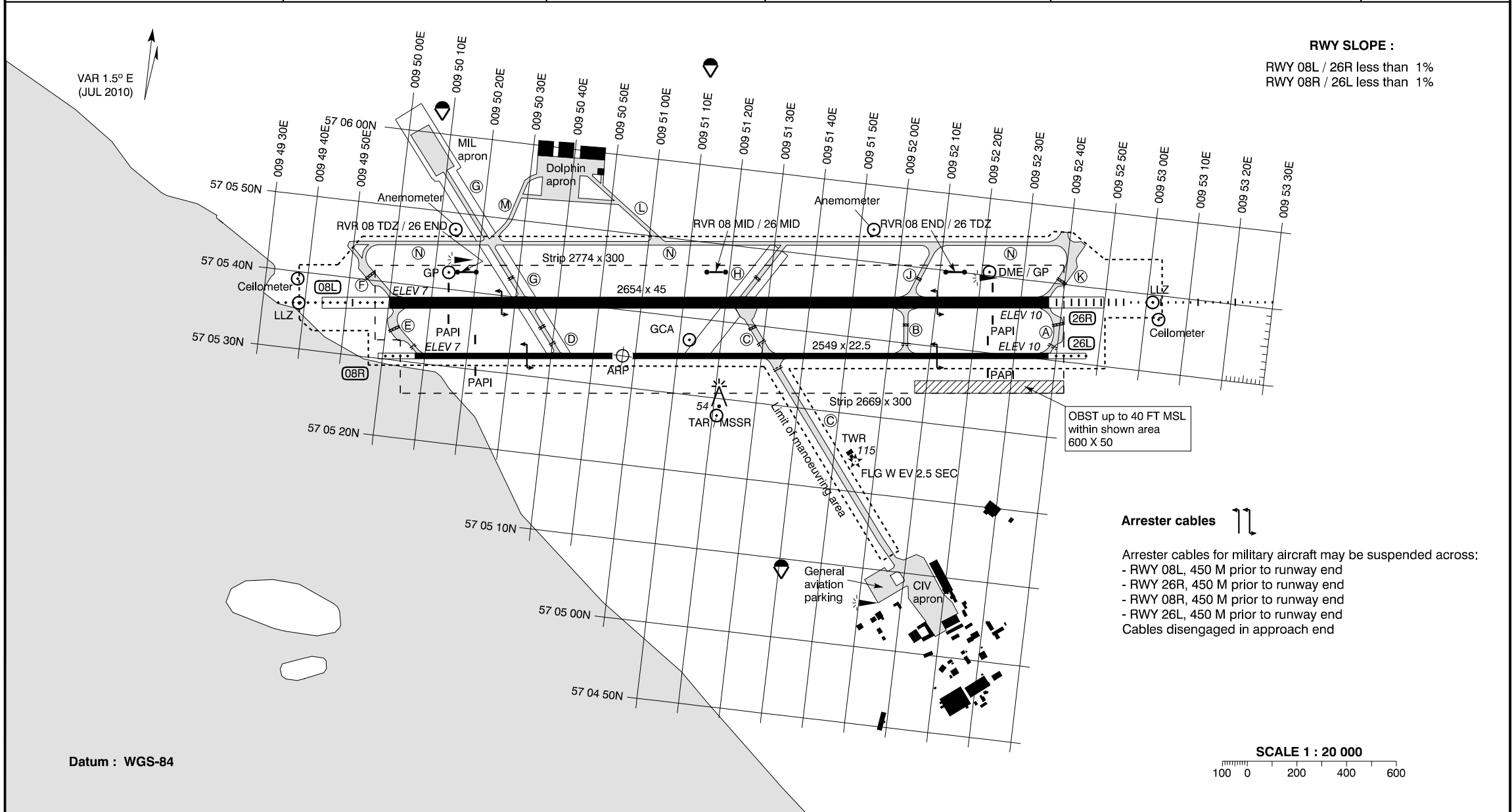

RUNWAYS														TAXIWAYS							
NR	Direction	THR PSN	Pavement Strength	Day marking	Declared distances				APCH and RWY LGT (Unless otherwise stated lighting is LIH adjustable)							Width :	Pavement :	Strength :	Day marking :	Lighting :	
					PSN TWY	TORA	TODA	ASDA	LDA	APCH	THR	TDZ	PAPI	Centre line	Edge						End
08L	083.3° GEO 081.8° MAG	57 05 37.37N 009 50 00.17E	Concrete / Asphalt PCN 64 R / D / X / U Composite construction	THR RWY NR TDZ Centre line Side stripes	E/F D/G C/H	2654 2070 1220	2654 2070 1220	2654 2070 1220	2654	470 M White	Green		2.75°	2650 M 15 M Standard colour	2650 M White	Red	TWY A : 23 M TWY B, TWY L, TWY M : 15 M TWY C, TWY D, TWY E : 22 M	Concrete / Asphalt	PCN 52 / R / D / X / U Composite construction	Centre line, Side stripes, Holding position	TWY A, TWY C, TWY D, TWY E: Blue edge RGL for RWY 08L / 26R
26R	263.3° GEO 261.8° MAG	57 05 47.44N 009 52 36.75E	Concrete / Asphalt PCN 64 R / D / X / U Composite construction	THR RWY NR TDZ Centre line Side stripes	A/K B/J C/H	2654 2070 1430	2654 2070 1430	2654 2070 1430	2654	900 M CAT II	Green	900 M White	2.75°	2650 M 15 M Standard colour	2650 M White	Red					
08R	083.3° GEO 081.8° MAG	57 05 30.87N 009 50 07.71E	Asphalt PCN 52 F / D / X / U	THR RWY NR Centre line Side stripes	E	2549	2549	2549	2549	150 M White LIL, Cross-bar 150 M from THR	Green LIL		2.75°		2550 M LIL	Red LIL					
26L	263.3° GEO 261.8° MAG	57 05 40.51N 009 52 38.08E	Asphalt PCN 52 F / D / X / U	THR RWY NR Centre line Side stripes	A	2549	2549	2549	2549	150 M White LIL, Cross-bar 150 M from THR	Green LIL		2.75°		2550 M LIL	Red LIL					

OTHER : Secondary power supply : Yes, switch-over time CAT II MAX 1 SEC, otherwise MAX 15 SEC

OBSTACLES : All obstacles are marked by day and night