

HELIPORT CHART - ICAO

Apron ELEV : 92 FT
HEL apron ELEV : 95 FT

Esbjerg AFIS : 120.150

AD 2 - EKEB
HEL
Esbjerg

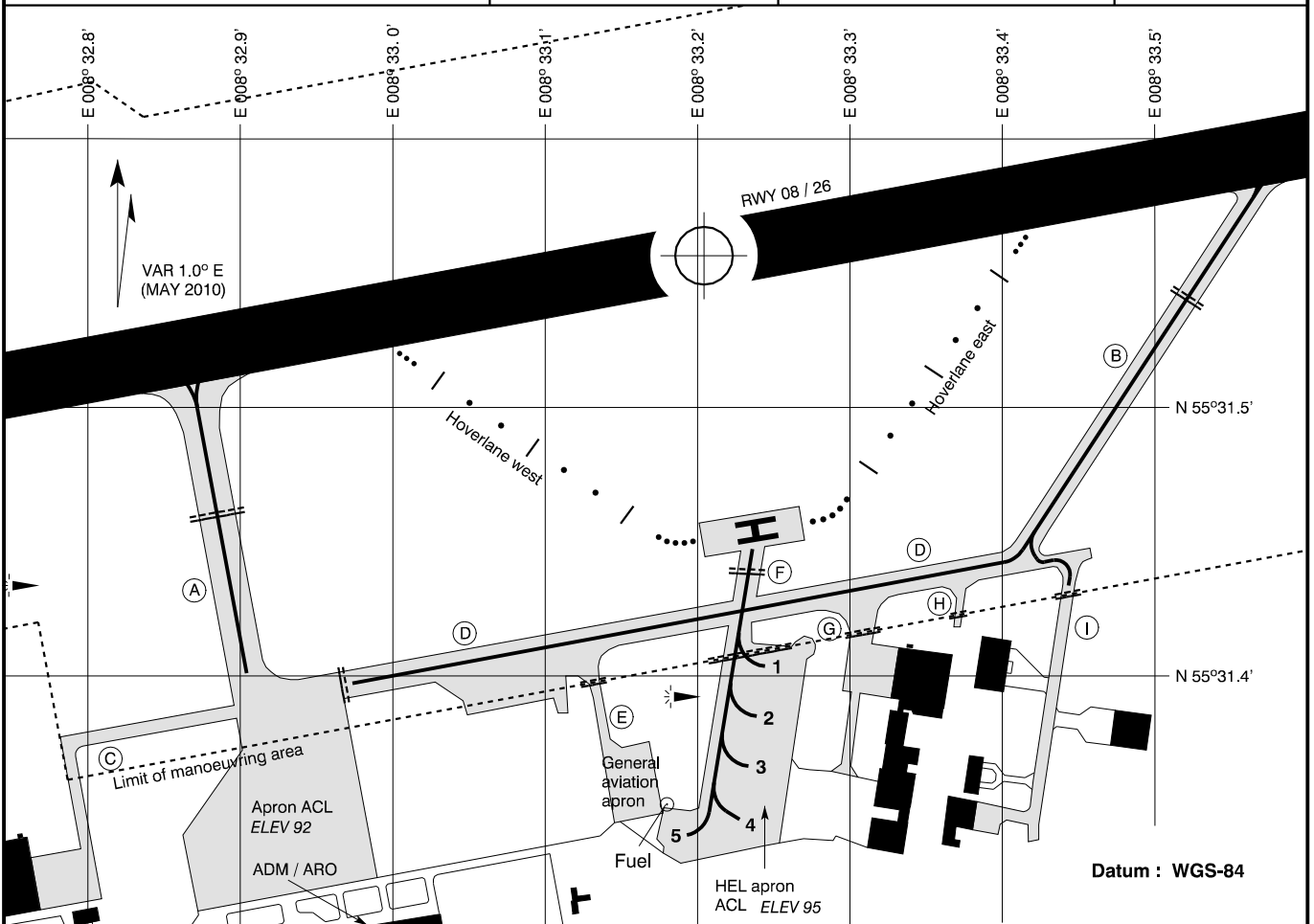

FATO - TLOF coordinates	55 31 27N 008 33 14E
Dimensions	28 x 69 M
Surface	Concrete
Strength (MTOM)	Unlimited
Markings	White edge, white "H"
FATO bearings	079° MAG 259° MAG
TLOF bearings	
Declared distances	-
TWY	15 M, asphalt
Lighting :	
Heliport beacon	-
APP	-
Alignment	Yellow hover lane
FATO edge	Green edge
TLOF edge	
Aiming point	-
TWY	Blue edge
Secondary power supply	MAX 15 SEC
Obstacles	-

APRON

Pavement : Asphalt
Strength : PCN 60 / R / A / W / T

HELICOPTER APRON

Pavement : Concrete
Strength : Unlimited
Marking : Marking dimensioned for type S 61

TAXIWAYS

See / Se aerodrome chart

Note ! Holding position on TWY F dimensioned for type S 61

HEL STANDS - PSN

1. 55 31 24.34N 008 33 14.82E
2. 55 31 23.25N 008 33 14.53E
3. 55 31 22.16N 008 33 14.24E
4. 55 31 21.08N 008 33 13.95E
5. 55 31 20.83N 008 33 11.54E

Changes : New WDI.